

High Performance End Launch Connector

PSF-S06-000/001 (QEL™ SMA)

www.gigalane.com



GigaLane Quick End Launch (QEL™ SMA) is designed for quick launch at the edge of PCB board up to 18 GHz. Specially designed leg immediately adjusts and firmly holds its attachment with the PCB. It is ideal solution for all active & speedy tests required in R&D. When compared with conventional end launch connector, it will effectually reduce soldering and assembly time when deployed in mass production.

► Specification

Electrical

Frequency	2.4mm	DC ~ 50 GHz
	2.92mm	DC ~ 40 GHz
	SMA	DC ~ 27 GHz
Impedance	50 Ω	
VSWR	Low VSWR	
Insulation Resistance	Low Insertion Loss	

Materials

Connector	Body	Stainless Steel (Passivated)
	Center Contract	Beryllium Copper (Gold Plated)
	Insulator	Engineering Plastic
Launch Block	Launched Block	Brass (Ni Plated)
	Pin	Beryllium Copper (Gold Plated)
	Insulator	PTFE

Environmental

Thermal Shock	MIL-STD-202, Method 107, Condition B
Corrosion (salt Spray)	MIL-STD-202, Method 101, Condition B, 5% salt
Shock	MIL-STD-202, Method 213, Condition I
Vibration	MIL-STD-202, Method 204, Condition D
Moisture Resistance	MIL-STD-202, Method 106

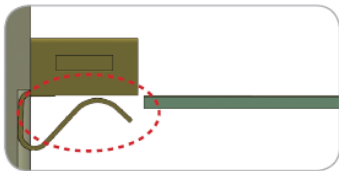
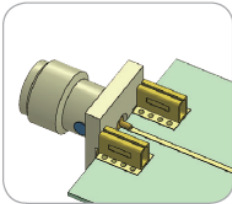
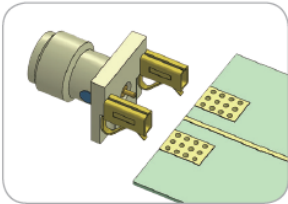

Easy & Speedy insertion

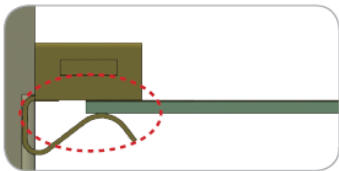

Uniquely designed legs maneuvers smoothly and evenly to fit the PCB thickness

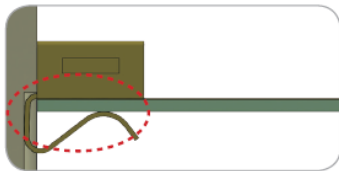

Built-in tension of legs enables even and firm attachment to the PCB

High Performance End Launch Connector

PSF-S06-000/001 (QEL™ SMA)

www.gigalane.com

Drawing

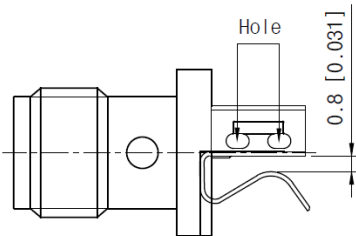
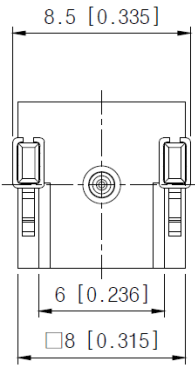
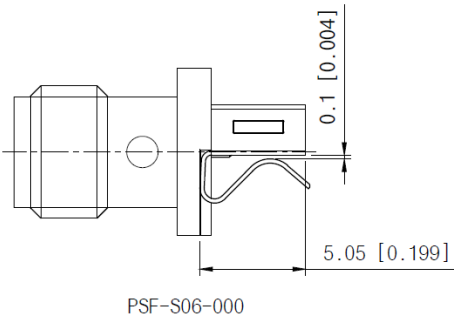

PSF-S06-001

Part No.	Board Clearance
PSF-S06-000	0.25 ~ 1.2mm
PSF-S06-001	1.25 ~ 2.0mm

Test result

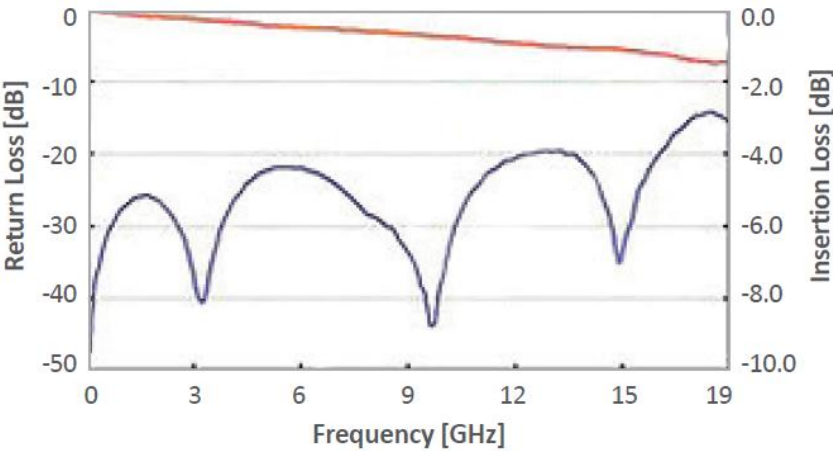

<DUT>

- Connector
 - PSF-S06-000 : 2ea
- PCB
 - FR4 Sub Thickness : 0.6mm
 - 50Ω Line Width : 1.2mm
 - Line Length : 18mm